

PART NUMBER	REV	FIRST USED
687928-1	V	854400-1
687928-2	V	565435-5
687928-3	V	354500-1
687928-4		
687928-5	B	565435-5
687928-6		
687928-7		
7-687928-7	U	

SEE DRAWING 687928-4  
OBSOLETE  
SEE DRAWING 687928-6  
SEE DRAWING 687928-7

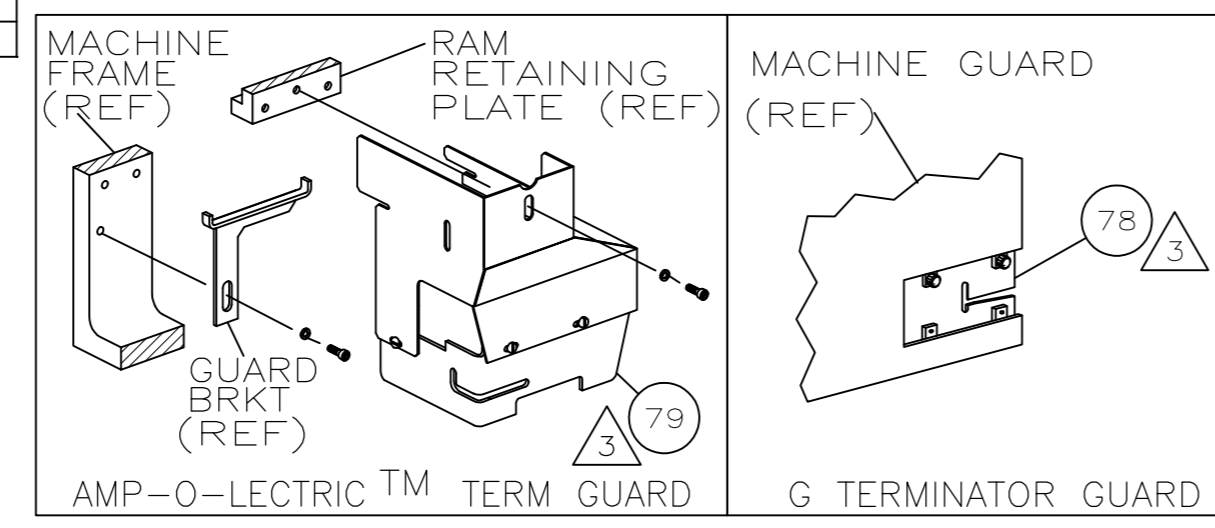

TERMINAL NAME: .187 FASTON™ RECEPTACLE					
CRIMPING DATA					
PAD LTR	CRIMP HEIGHT	WIRE SIZE			
A	.060 ±.002 [1.52 ±0.05mm]	16			
B	.053 ±.002 [1.35 ±0.05mm]	18			
C	.051 ±.002 [1.29 ±0.05mm]	(2) 22			
D	.049 ±.002 [1.24 ±0.05mm]	20			
CRIMP WIRE	SIZE	TYPE	RANGE		
	.090 [2.29mm]	F	20-16		
INSUL	SIZE	TYPE	RANGE		
	.140 [3.56mm]	F	.090-.130		
WIRE STRIP LENGTH	TERM APPL SPEC	FEED	APPL INSTRUCTION	SET UP GAGE	LAYOUT
.146-.176	114-2036	.650	408-8039	458638-1	12

LOC	DIST	REVISIONS			
F	LTR	DESCRIPTION	DATE	DN	APVD
A	66	ECR-09-011639	5-2009	MY	TE

REV	DESCRIPTION	DATE	BY	CHKD
-1	LEADMAKER & BENCH MODEL G			
-2	BENCH MODEL K			
-3	MECH POST FEED			
-7	MECH PRE FEED BENCH MODEL G			
-77	SPARE TOOLING KIT			

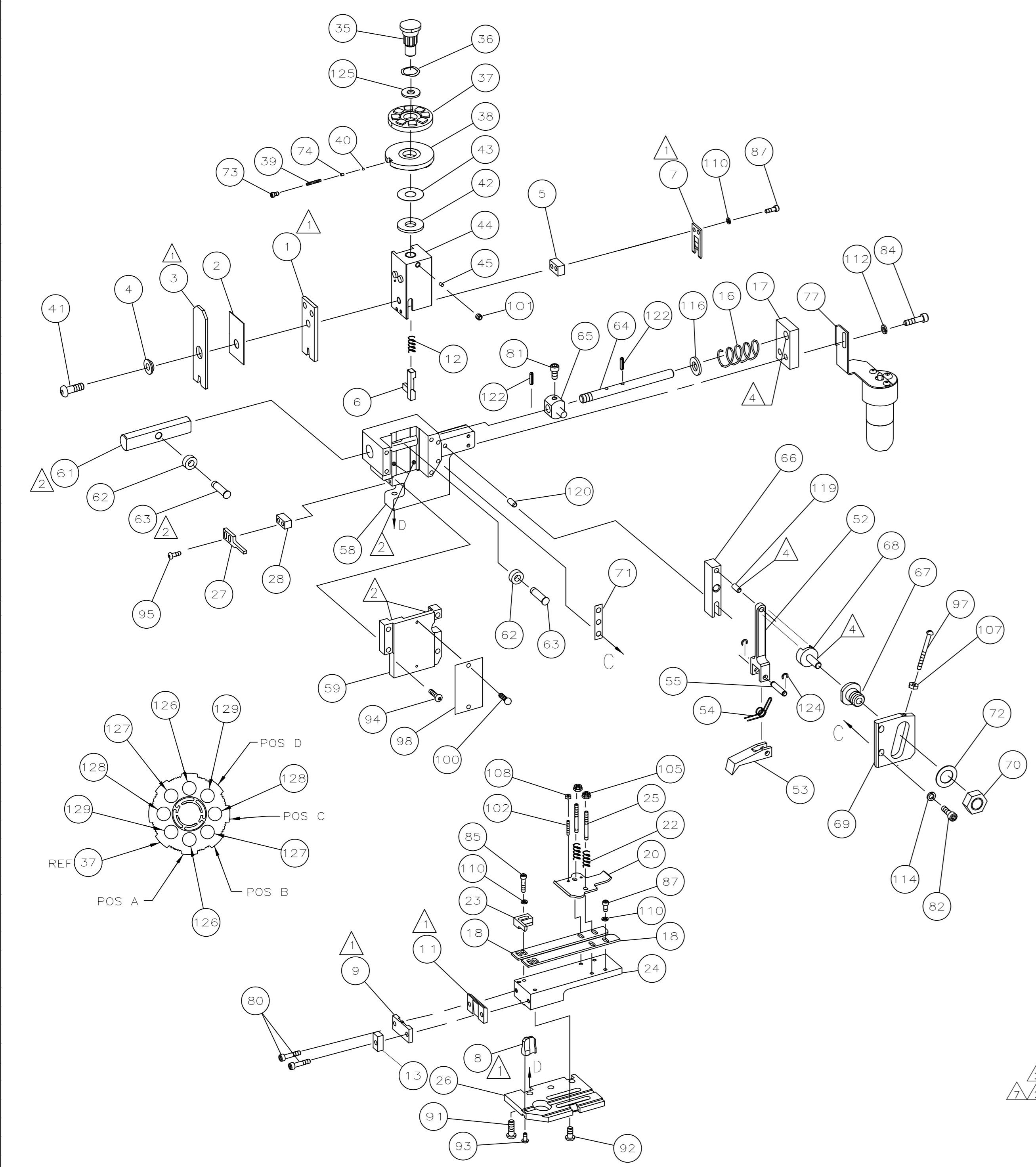

QTY REQD PER ASSY	PART NO	DESCRIPTION	ITEM NO		
2	6-354779-4	PIN, WIRE DISC (.3310)D	129		
2	6-354779-0	PIN, WIRE DISC (.3290)C	128		
2	5-354779-6	PIN, WIRE DISC (.3270)B	127		
2	4-354779-2	PIN, WIRE DISC (.3200)A	126		
1	986950-1	WASHER, FLAT PRECISION	125		
REF	21045-3	RING, RET "C" (Ø.187)FD PIN	124		
REF	5-21028-1	PIN, STD SPRING (Ø.12)FD ADJ ROD	122		
REF	1-21030-7	PIN, DOWEL (Ø.187x1.50)HSG	120		
REF	1-21030-1	PIN, DOWEL (Ø.187x.50)LEVER	119		
REF	21899-4	WASHER, FLAT (Ø5/16)SCR ADJ	116		
REF	21024-5	WASHER, LOCK (NO.10)FD ADJ PL	114		
REF	21024-5	WASHER, LOCK (NO.10)FD ROD GDE	112		
7	21024-4	WASHER, LOCK (NO.8)SHEAR BL	110		
2	21018-4	NUT, HEX (4-40)DRAG	108		
REF	21018-5	NUT, HEX (6-32)FD ADJ PL	107		
2	21022-2	NUT, HEX SL (8-32)DRAG STUD	105		
2	2-21006-6	SCR, SKT SET (4-40x.62)DRAG	102		
1	21009-2	SCR, SKT SET (1/4-20x.25)RAM	101		
2	21017-2	SCR, DRIVE (#2x.19)ID PLATE	100		
1	1-21002-7	SCR, BHC (6-32x.38)CAM	99		
1	461264-1	PLATE, IDENTIFICATION	98		
REF	6-23715-5	SCR, PAN HD (6-32x1.50)FEED ADJ	97		
2	2-21002-2	SCR, BHC (8-32x.50)STRIPPER	95		
REF	2-21002-9	SCR, BHC (10-32x.75)HSG CAP	94		
1	22733-8	SCR, BHC (8-32x.38 LW)ANVIL	93		
4	3-21002-3	SCR, BHC (1/4-20x.50)ST GD PL	92		
REF	2-22733-8	SCR, BHC (1/4-20x.62)BASE PL	91		
5	2-21000-6	SCR, SHC (8-32x.38)SLUG BLADE	87		
2	2-21000-9	SCR, SHC (8-32x.75)R STP GUIDE	85		
REF	3-21000-7	SCR, SKT CAP (10-32x.75)FD GDE	84		
REF	3-21000-6	SCR, SKT CAP (10-32x.62)FD ADJ P	82		
REF	3-21000-4	SCR, SKT CAP (10-32x.38)PIVOT BL	81		
2	2-21002-9	SCR, BHC (10-32x.75)SH PL	80		
REF	455745-1	GUARD, WINDOW	79		
REF	679532-1	INSERT, GUARD	78		
REF	465184-9	LUBRICANT ASSY	77		
1	690603-1	SPRING, ASSIST	74		
1	23030-1	SCR, SKT CAP (6-32x.25)CP DSC	73		
REF	458109-1	WASHER, FLAT (SPECIAL)	72		
REF	690517-1	SPACER	71		
-77	-3	-2	-1	U/M	

QTY REQD PER ASSY	PART NO	DESCRIPTION	ITEM NO		
REF	22594-8	NUT, HEX	70		
REF	240628-1	PLATE, ADJ	69		
REF	240626-1	SHAFT, PIVOT	68		
REF	240635-1	BUSHING	67		
REF	455680-1	LEVER, INTERMEDIATE	66		
REF	240629-1	BLOCK, PIVOT	65		
REF	240632-2	SCR, ADJ	64		
REF	240659-3	PIN, CAM ROLLER	63		
REF	240658-1	CAM, ROLLER	62		
REF	454398-1	ROD, FEED	61		
REF	454220-1	CAP, RAM	59		
REF	453736-1	HOUSING	58		
REF	240624-1	PIN, FEED FINGER	55		
REF	691499-1	SPRING, FEED FINGER	54		
REF	240635-1	FINGER, FEED	53		
REF	240634-1	LEVER, TERMINAL	52		
1	690602-6	CAM, PRE-FEED 1 5/8 ST	49		
1	690501-3	CAM, POST-FEED 1 1/8 ST	48		
1	690501-4	CAM, POST-FEED 1 5/8 ST	47		
1	690191-1	PLUG, NYLON	45		
1	455674-1	RAM	44		
1	690125-1	WASHER, LAMINATED	43		
1	690124-1	WASHER, RAM	42		
1	7-21002-9	BOLT, CRIMPER (5/16-24x1.00)	41		
1	23241-6	BALL, STEEL	40		
1	690170-1	SPRING, COMPRESSION	39		
1	690142-1	DISC, INSULATION	38		
1	354777-1	WIRE DISC, PLASTIC	37		
1	22480-5	WASHER, SPRING	36		
1	690212-1	POST, RAM	35		
1	458980-1	APPLICATOR, BASIC (SUB ASSY)	32		
1	3-690451-2	SPACER, STRIPPER	28		
1	240639-1	STRIPPER	27		
REF	455676-1	PLATE, BASE	26		
2	22354-8	DRAG, STUD	25		
1	455678-3	PLATE, STRIP GUIDE	24		
1	240825-1	PLATE, STRIP HOLD DOWN	23		
2	4-22281-1	SPRING, DRAG	22		
1	454177-1	DRAG, STOCK	20		
2	454204-3	GUIDE, STRIP (FRONT)	18		
REF	454178-1	GUIDE, FEED ROD	17		
REF	4-22284-9	SPRING, FEED RETURN	16		
1	1-690481-3	SPACER, HOLD DOWN	13		
1	23846-1	SPRING, HOLD DOWN	12		
1	240644-5	PLATE, REAR SHEAR	11		
1	1-690495-9	PLATE, FRONT SHEAR	9		
1	7-356038-8	ANVIL	8		
1	690474-6	BLADE, SLUG	7		
1	1-455892-2	HOLD DOWN, TERMINAL	6		
1	6-240641-4	SPACER, SLUG BLADE	5		
1	238009-1	SPACER, BLOCK CRIMPER	4		
1	1-456134-4	CRIMPER, INSULATION	3		
1	455888-4	SPACER, CRIMPER	2		
1	7-1490019-7	CRIMPER, WIRE	1		
-77	-3	-2	-1	U/M	

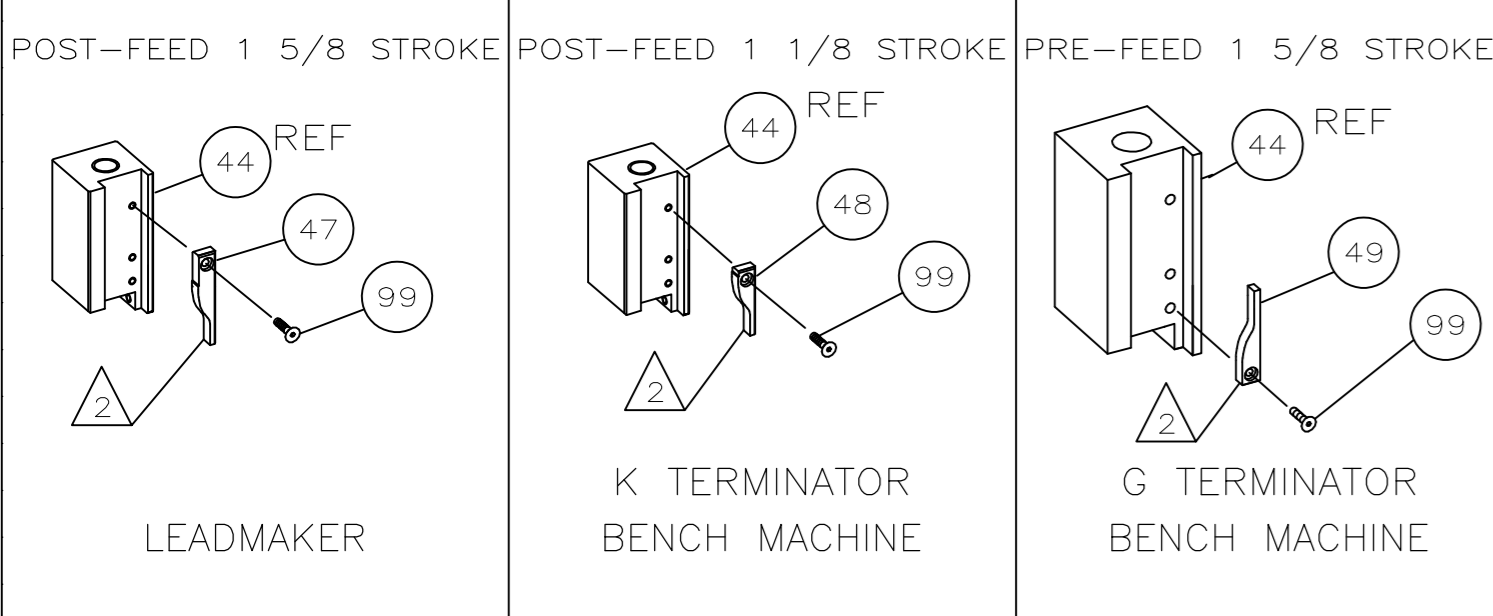

- 1 RECOMMENDED SPARE PARTS.
- 2 GREASE LIGHTLY.
- 3 GUARD MUST BE IN PLACE WHEN OPERATING APPLICATOR IN A BENCH MACHINE.
- 4 LUBRICATE DAILY USING NO. 20 MACHINE OIL.
- 5 ITEMS WITH QTY OF REF SPECIFIED (EXCEPT ITEMS 78 AND 79) ARE USED ON ITEM 32.
- 6 INSULATION RANGE FOR 62137 ONLY IS .060-.110
- 7 ITEM 78 USED WITH BENCH G TERMINATOR ONLY.

THIS DRAWING IS A CONTROLLED DOCUMENT.

DWN: R.O. WILSON 2/10/95  
CHK: C. FERISMAN 2-13-94  
APVD: J. ELBIN 2-14-94

Tyco Electronics Corporation  
Harrisburg, PA 17105-3608

END FEED HDM APPLICATOR

SIZE: A1  
CAGE CODE: 00779  
DRAWING NO: 687928

CUSTOMER DRAWING

SCALE: 1 of 1  
REV: V1