

PART NUMBER	REV	DESCRIPTION	PROGRAMMED MEMORY CHIP
1911011-1	B	CUTS CARRIER	8-1911011-1
1911011-6	B	CONTINUOUS CARRIER	8-1911011-6
7-1911011-1	B	-1 AND SPARE PARTS	9-1911011-1
7-1911011-6	B	-6 AND SPARE PARTS	9-1911011-6
7-1911011-7	B	SPARE PARTS KIT	-

APPLICATOR DATA		
CRIMP	SIZE	TYPE
WIRE	2.03mm [.080]	F
INSUL	4.06mm [.160]	O
APPL INSTRUCTIONS 408-10135		

TERMINAL DATA: TE TERMINAL		TYCO ELECTRONICS CRIMP SPEC	
TERMINAL NAME: JUNIOR POWER TIMER CONTACT			
WIRE STRIP LENGTH 4.4-5.0mm [.173-.197]		INSULATION DIAMETER RANGE 1.20-2.99mm [.047-.118]	
TERMINAL APPL SPEC 114-18050			

TE TERMINAL	TE TERMINAL	TE SEAL	TE SEAL
929939-3	927770-3	828904	828905
929939-1	927770-6	828904	828905
929939-6	927770-8	828904	828905
1-929939-1	1-927770-1	828904	828905
2-929939-1	2-927770-1	828904	828905
927770-1	929280-1	828904	828905

WIRE SIZE	CRIMP HEIGHT
mm [INCH]	mm [INCH]
1mm2	1.36±.05 [.054±.002]
0.85mm2	1.32±.05 [.052±.002]
0.75mm2	1.27±.05 [.050±.002]
0.5mm2	1.18±.05 [.046±.002]

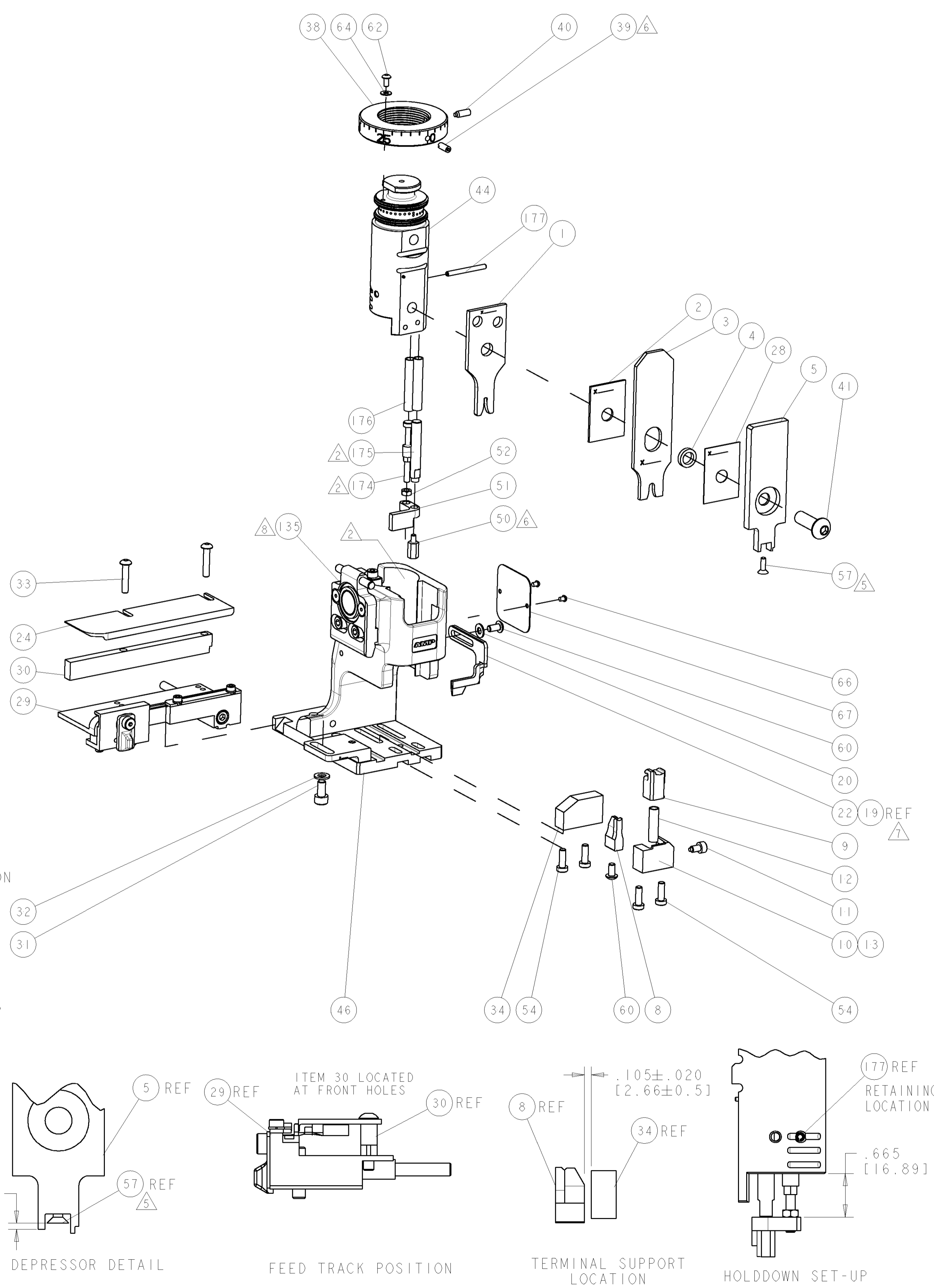

- 1 RECOMMENDED SPARE PARTS.
- 2 GREASE BEARING SURFACES LIGHTLY.
- 3. LUBRICATE DAILY PER THE APPLICATOR INSTRUCTION SHEET SUPPLIED WITH THE APPLICATOR.
- 4 THIS APPLICATOR APPLIES TERMINAL WITH A SEAL. WIRE INSULATION DIA IS DEPENDENT ON SEAL BEING APPLIED. SEE APPL. SPEC. FOR DETAILS.
- 5 APPLY TORQ-SEAL IN ALLEN SOCKET TO FILL HOLE AFTER FLAT HD HAS BEEN ADJUSTED TO CORRECT HEIGHT AT QUALIFICATION. APPLY P/N 1-23419-5 LOCTITE(R) TO THREADS.
- 6 APPLY P/N 1-23419-5 LOCTITE(R) TO THREADS.
- 7 ITEM 19 - OPTIONAL STRIPPER FOR BENCH MACHINE APPLICATION.
- 8 APPLICATOR SPECIFIC DATA TO BE ENTERED INTO BLANK MEMORY CHIP AT ASSEMBLY.

FEED FINGER	SET UP GAGE	LOC	DIST	REVISIONS					
1901694-1	1901040-1	A	66	P	LTR	DESCRIPTION	DATE	DWN	APPR
				A1		ECR-07-004822	01MAR2007	RD	ND
				B		ECR-07-011464	22MAY2007	GH	ND

QTY	REV	REF	REF	REF	REF	DESCRIPTION	ITEM NO	
-	1	1	1	1	1	1-993111-6	PIN, SLOTTED SPRING 3.0 X 30.0	177
-	2	2	2	2	2	3-22280-7	SPRING, COMPRESSION	176
-	1	1	1	1	1	1752353-1	GUIDE PIN, HOLDDOWN	175
-	1	1	1	1	1	1901680-1	GUIDE PIN, HOLDDOWN	174
-	REF	REF	REF	REF	REF	SEE TABLE	MEMORY CHIP, PROGRAMMED	135
-	1	1	1	1	1	1633565-1	DOCUMENTATION PACKAGE	71
-	1	1	1	1	1	1901048-1	TAG, IDENTIFICATION	67
-	2	2	2	2	2	21017-1	SCREW, DRIVE	66
-	1	1	1	1	1	18028-1	WASHER, FLAT, REG M3	64
-	1	1	1	1	1	1655785-9	SCR, BTN SKT HD CAP (M3 X 6)	62
-	2	2	2	2	2	1655785-1	SCR, BTN SKT HD CAP (M4 X 8)	60
-	1	1	1	1	1	985575-3	SCR, FLT SKT HD CAP M3 X 10.0	57
-	4	4	4	4	4	1655783-3	SCR, CAP, SOC HD, LOW HEAD, M4 X 12	54
-	1	1	1	1	1	1-18030-0	NUT, HEX, REG M3.5	52
-	1	1	1	1	1	1901681-1	HOLDDOWN, TERMINAL	51
-	1	1	1	1	1	2-1752354-5	STANDOFF, HOLD-DOWN	50
-	1	1	1	1	1	1752300-1	SF SYSTEM III APPLICATOR	46
-	1	1	1	1	1	1752308-1	RAM	44
-	1	1	1	1	1	2-1655785-3	SCR, BTN SKT HD CAP (M8 X 25)	41
-	1	1	1	1	1	993002-4	SCREW, SET, SFT TIP	40
-	1	1	1	1	1	1962043-1	PLUNGER, BALL, METRIC	39
-	1	1	1	1	1	1752309-1	RING, INSULATION CRIMP	38
-	1	1	1	1	1	1-1752356-3	SUPPORT, TERMINAL	34
-	2	2	2	2	2	3-1655785-3	SCR, BTN SKT HD CAP (M4 X 20)	33
-	1	1	1	1	1	18028-3	WASHER, FLAT, REG M5	32
-	1	1	1	1	1	5-1655316-3	SCR, SKT HD CAP, M5 X 10.0	31
-	1	1	1	1	1	1-1320908-5	SPACER, STRIP GUIDE	30
-	1	1	1	1	1	1901087-1	ASSEMBLY, STRIP GUIDE	29
-	1	1	1	1	1	455888-3	SPACER, CRIMPER	28
-	1	1	1	1	1	1320928-1	PLATE, STRIP GUIDE	24
-	1	1	1	1	1	1976045-1	STRIPPER	22
-	1	1	1	1	1	18028-2	WASHER, FLAT, REG M4	20
-	REF	REF	REF	REF	REF	1752311-1	STRIPPER	19
-	1	1	1	1	1	1338684-2	SHEAR HOLDER, FRONT	13
-	1	1	1	1	1	3-22280-3	SPRING, COMPRESSION	12
-	1	1	1	1	1	356885-5	STOP, SHEAR	11
-	1	1	1	1	1	1-1320921-0	SHEAR HOLDER, FRONT, CUT	10
-	1	1	1	1	1	318707-1	FLOATING SHEAR, FRONT	9
-	1	2	1	1	1	9-1333204-9	ANVIL, COMBINATION	8
-	1	1	1	1	1	1338680-1	DEPRESSOR, SHEAR	5
-	1	1	1	1	1	3-238011-3	BLOCK, CRIMPER SPACER	4
-	1	2	1	1	1	8-683454-9	CRIMPER, INSULATION O	3
-	1	1	1	1	1	1-455888-1	SPACER, CRIMPER	2
-	1	2	1	1	1	1-456405-5	CRIMPER, WIRE PREMIUM	1

DIMENSIONS:		TOLERANCES UNLESS OTHERWISE SPECIFIED:		APPROVED:		DRAWN:		DATE:	
INCHES	MM	PLC	±	DATE	DATE	DATE	DATE	DATE	DATE
		0	±	15DEC2006	15DEC2006	15DEC2006	15DEC2006	15DEC2006	15DEC2006
		1	±						
		2	±						
		3	±						
		4	±						
		5	±						
		6	±						
		7	±						
		8	±						
		9	±						
		10	±						
		11	±						
		12	±						
		13	±						
		14	±						
		15	±						
		16	±						
		17	±						
		18	±						
		19	±						
		20	±						
		21	±						
		22	±						
		23	±						
		24	±						
		25	±						
		26	±						
		27	±						
		28	±						
		29	±						
		30	±						
		31	±						
		32	±						
		33	±						
		34	±						
		35	±						
		36	±						
		37	±						
		38	±						
		39	±						
		40	±						
		41	±						
		42	±						
		43	±						
		44	±						
		45	±						
		46	±						
		47	±						
		48	±						
		49	±						
		50	±						
		51	±						
		52	±						
		53	±						
		54	±						
		55	±						
		56	±						
		57	±						
		58	±						
		59	±						
		60	±						
		61	±						
		62	±						
		63	±						
		64	±						
		65	±						
		66	±						
		67	±						
		68	±						
		69	±						
		70	±						
		71	±						
		72	±						
		73	±						
		74	±						
		75	±						
		76	±						
		77	±						